

Application: AXOR / OM457

293.01.1000

**293.01.2000
(WITH GEAR)**

OEM	OE
4123520260	457 130 67 15
4123520140	457 130 44 15
	457 130 24 15

Cylinder Bore	Ø85
Stroke	62 mm
Swept Volume	352 cc
Air Inlet Port Size	M30x1.5
Air Delivery Port Size	M26x1,5
Number of Cylinders	1
Through Drive	Yes
Unloader Port Size	M12x1.5
Water Or Air Cooled	W
Water Inlet Port Size	M16x1.5
Water Delivery Port Size	M16x1.5
Water Cooled Valve Plate	Yes

Components

283.01.1100	Crankcase	OEM	OE
		4123520116	
		4129050112	

283.01.1200	Cylinder Head	OEM	OE
		4123529222	0011301215
			0011302615
			0011305219

283.01.1220	Cylinder Upper Head	OEM	OE

283.01.1230	Cylinder Lower Head	OEM	OE

283.01.1300	Coolant Plate	OEM	OE

283.01.1400	Connecting Rod	OEM	OE
		9111457382	0001312517
			0001312917

293.01.1500	Crankshaft	OEM	OE
		4129056904	

283.01.1600	Bearing Cover	OEM	OE
		4111476034	0001312932

283.01.1610	Bushing	OEM	OE
		9115532044	

293.01.1580	Nut For Crankshaft	OEM	OE
		8103410034	0029906650

136.01.1700	Piston With Rings (STD)	OEM	OE
		9115016242	1283781
		9115016252	1698686
		912006272	0001303417
			0001305317
			81541196040
	136.01.1700-Ø85.00 mm		
	136.01.1710-Ø85.25 mm		
	136.01.1720-Ø85.50 mm		
	136.01.1730-Ø85.75 mm		
	136.01.1740-Ø86.00 mm		

132.01.1800	Piston Ring Kit (STD)	OEM	OE
		9115019202	3094621
		9118019202	0011311111
	132.01.1800-Ø85.00 mm		
	132.01.1810-Ø85.25 mm		
	132.01.1820-Ø85.50 mm		
	132.01.1830-Ø85.75 mm		
	132.01.1840-Ø86.00 mm		

293.01.2350 Repair Kit w/o Bushing



OEM	OE

293.01.2310 Repair Kit With Plate



OEM	OE

293.01.2330 Repair Kit



OEM	OE

283.01.1280 Head Repair Kit

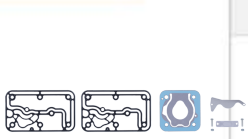

OEM	OE

293.01.2100 Gasket & Sealing Kit

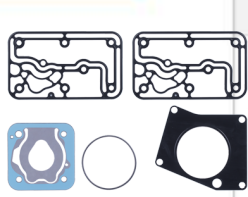

OEM	OE
4123529232	0011302615

136.01.2200 Valve Kit



OEM	OE

136.01.2500 Unloader Valve Kit

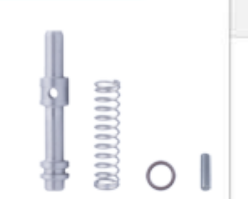

OEM	OE

295.01.2106 Gasket for Crankcase



OEM	OE
9121101404	4571310180

136.01.1900 Cap



OEM	OE
8950735894	1304881 3094835 11712508 0001312321

283.01.2900 Gear



OEM	OE
8959051884	4571320905

136.01.2700 Screw Kit



OEM	OE
8912119994	