

Application: 440 cc

OEM	OE
KZ1087/4N 2W440R	KZ1087/4N

Cylinder Bore	Ø75
Stroke	50
Swept Volume	440
Air Inlet Port Size	3/4"-14 NPSI
Air Delivery Port Size	3/4"-14 NPSI
Number of Cylinders	2
Through Drive	Yes
Unloader Port Size	-
Water Or Air Cooled	W
Water Inlet Port Size	1/2"-14 NPSI
Water Delivery Port Size	3/4"-14 NPSI
Water Cooled Valve Plate	Yes

Components

659.01.1200	Cylinder Head	OEM	OE

659.01.1210	Cylinder Head With Plate Kit	OEM	OE

659.01.1300	Plate Kit	OEM	OE

659.01.1400	Connecting Rod	OEM	OE

101.01.1580	Nut For Crankshaft	OEM	OE
		KW3820-1	39949

659.01.1600	Bearing Cover	OEM	OE

630.01.2600	Bushing	OEM	OE

132.01.1103	Bearing	OEM	OE
		8952510202	697888 1698671

659.01.1700	Piston With Rings (STD)	OEM	OE
659.01.1700-Ø75.00 mm 659.01.1710-Ø75.25 mm 659.01.1720-Ø75.50 mm 659.01.1730-Ø75.75 mm 659.01.1740-Ø76.00 mm			

659.01.1701	Piston (STD)	OEM	OE
659.01.1701-Ø75.00 mm 659.01.1711-Ø75.25 mm 659.01.1721-Ø75.50 mm 659.01.1731-Ø75.75 mm 659.01.1741-Ø76.00 mm			

659.01.1800	Piston Ring Kit (STD)	OEM	OE
659.01.1800-Ø75.00 mm 659.01.1810-Ø75.25 mm 659.01.1820-Ø75.50 mm 659.01.1830-Ø75.75 mm 659.01.1840-Ø76.00 mm			

659.01.2300	Repair Kit With Bushing	OEM	OE

659.01.2320 Repair Kit

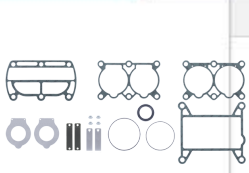

OEM	OE

659.01.2350 Repair Kit w/o Bushing

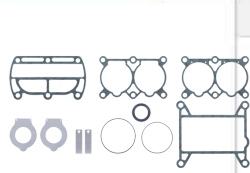

OEM	OE

659.01.2100 Gasket & Sealing Kit

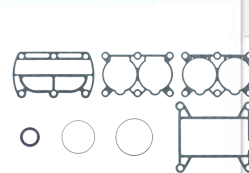

OEM	OE

659.01.2200 Valve Kit



OEM	OE

OEM	OE

OEM	OE

OEM	OE

OEM	OE

OEM	OE

OEM	OE

OEM	OE

OEM	OE

OEM	OE

OEM	OE

OEM	OE

OEM	OE

OEM	OE

OEM	OE

OEM	OE

OEM	OE

OEM	OE

OEM	OE

OEM	OE

OEM	OE

OEM	OE

OEM	OE

OEM	OE

OEM	OE

OEM	OE

OEM	OE

OEM	OE