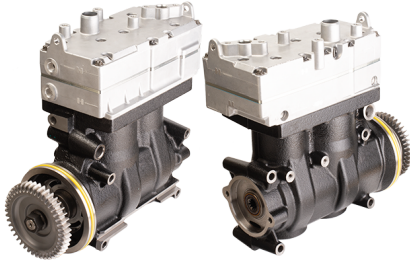

Application: EURO 6

OEM	OE
9127180010	2020653

Cylinder Bore	Ø100/Ø75
Stroke	56/28
Swept Volume	440/124
Air Inlet Port Size	Ø25
Air Delivery Port Size	Ø20
Number of Cylinders	2
Through Drive	Yes
Unloader Port Size	M14x1.5
Water Or Air Cooled	W
Water Inlet Port Size	M16 x 1.5
Water Delivery Port Size	M16x1.5
Water Cooled Valve Plate	Yes

Components

737.01.1100	Crankcase	OEM	OE

737.01.1200	Cylinder Head	OEM	OE

737.01.1220	Cylinder Upper Head	OEM	OE

737.01.1230	Cylinder Lower Head	OEM	OE

737.01.1300	Coolant Plate	OEM	OE

737.01.1400	Connecting Rod	OEM	OE

737.01.1460	Connecting Rod	OEM	OE

737.01.1500	Crankshaft	OEM	OE

512.01.1510	Pump Adapter	OEM	OE
	9122106404		

102.01.1580	Nut For Crankshaft	OEM	OE
	464642 1315273 1698672 1698672 464642		

143.01.3600	Adapter	OEM	OE
	9120003404		

513.01.1700	Piston With Rings (STD)	OEM	OE
	513.01.1700-Ø100.00 mm 513.01.1710-Ø100.25 mm 513.01.1720-Ø100.50 mm 513.01.1730-Ø100.75 mm 513.01.1740-Ø101.00 mm		

513.01.1800 Piston Ring Kit (STD)

513.01.1800-Ø100.00 mm
 513.01.1810-Ø100.25 mm
 513.01.1820-Ø100.50 mm
 513.01.1830-Ø100.75 mm
 513.01.1840-Ø101.00 mm

OEM	OE

737.01.1700 Piston With Rings (STD)

737.01.1700-Ø75.00 mm
 737.01.1710-Ø75.25 mm
 737.01.1720-Ø75.50 mm
 737.01.1730-Ø75.75 mm
 737.01.1740-Ø76.00 mm

OEM	OE

737.01.1800 Piston Ring Kit (STD)

737.01.1800-Ø75.00 mm
 737.01.1810-Ø75.25 mm
 737.01.1820-Ø75.50 mm
 737.01.1830-Ø75.75 mm
 737.01.1840-Ø76.00 mm

OEM	OE

737.01.2300 Repair Kit With Bushing

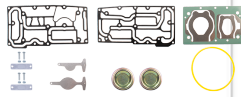

OEM	OE

737.01.2350 Repair Kit w/o Bushing

OEM	OE

737.01.2310 Repair Kit With Bushing & Piston

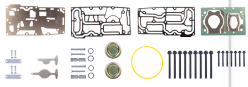

OEM	OE

737.01.2330 Repair Kit

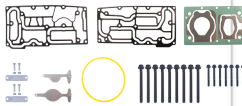
OEM	OE

737.01.2320 Repair Kit

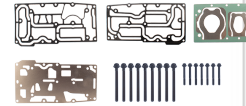
OEM	OE

737.01.2340 Repair Kit

OEM	OE

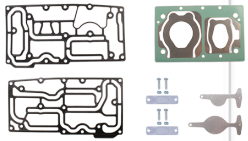
737.01.1280 Head Repair Kit

OEM	OE

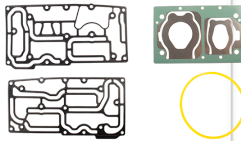
737.01.2100 Gasket & Sealing Kit

OEM	OE

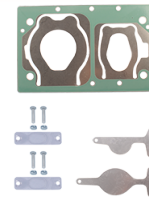
737.01.2200 Valve Kit

OEM	OE

737.01.2500 Unloader Valve Kit

OEM	OE

136.01.1900 Cap

OEM	OE
8950735894	1304881 3094835 11712508 0001312321

143.01.2600 Bushing

OEM	OE

549.01.2900 Gear

OEM	OE
	1906757 2126048

737.01.2700 Screw Kit

OEM	OE