



OEM	OE
Tu-Flo550	1516307C91
107007	23514502
107099	
107513	
65204	

Cylinder Bore	Ø70,61
Stroke	19
Swept Volume	297.6
Air Inlet Port Size	-
Air Delivery Port Size	-
Number of Cylinders	2
Through Drive	Yes
Unloader Port Size	1/8'-27 NPT
Water Or Air Cooled	W
Water Inlet Port Size	1/2'-14 NPT
Water Delivery Port Size	1/2'-14 NPT
Water Cooled Valve Plate	Yes

Components

823.01.1100	Crankcase	OEM	OE

712.01.1200	Cylinder Head	OEM	OE
		107082	9P920283

712.01.1400	Connecting Rod	OEM	OE
		108841	

712.01.1410	Big end Bearing	OEM	OE
		107651	

712.01.1470	Connecting Rod & Piston Rep	OEM	OE
		108843	

7159.01.1500	Crankshaft	OEM	OE

636.01.1580	Nut For Crankshaft	OEM	OE

735.01.1600	Bearing Cover	OEM	OE

712.01.1700	Piston With Rings (STD)	OEM	OE
712.01.1700-Ø70.64 mm 712.01.1710-Ø70.89 mm 712.01.1720-Ø71.14 mm 712.01.1730-Ø71.39 mm 712.01.1740-Ø71.64 mm			

712.01.1701	Piston (STD)	OEM	OE
		107647	
712.01.1701-Ø70.64 mm 712.01.1711-Ø70.89 mm 712.01.1721-Ø71.14 mm 712.01.1731-Ø71.39 mm 712.01.1741-Ø71.64 mm			

712.01.1800	Piston Ring Kit (STD)	OEM	OE
		5005361 107639	
712.01.1800-Ø70.64 mm 712.01.1810-Ø70.89 mm 712.01.1820-Ø71.14 mm 712.01.1830-Ø71.39 mm 712.01.1840-Ø71.64 mm			

672.01.2600	Bushing	OEM	OE
			AK2500350R

636.01.2900 Gear



OEM

OE

8929721
8929721

712.01.2350 Repair Kit w/o Bushing



OEM

OE

107516

107516
2K200296

712.01.2320 Repair Kit

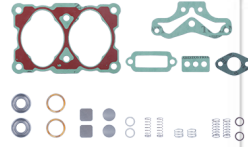

OEM

OE

712.01.2100 Gasket & Sealing Kit



OEM

OE

712.01.2200 Valve Kit

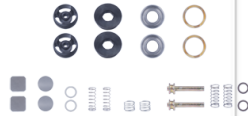

OEM

OE